

FIRST BAPTIST SUFFOLK
Quarterly Business Meeting
January 12, 2021
6:30pm

AGENDA

Devotion and Prayer

Call to Order

Mike Dolen, Moderator

Old Business

Reading / Approval of Minutes
(Previous Meetings)

Cindy Baker, Church Clerk

Reports, Recommendations & Elections

Church Clerk's Report

Cindy Baker, Church Clerk

Finance Committee
Quarterly Report

Alan Harris, Chair

Board of Directors
Proposal- Building usage request from SCA.

Alan Harris, President

New Business

No Items for Discussion or Motions Were Submitted.

Motion to Adjourn

Benediction

FIRST BAPTIST SUFFOLK
237 N Main Street
Suffolk, VA 23434

CLERK'S REPORT 1st QUARTER 2021-2022

MEMBERS JOINED BY TRANSFER OF LETTER OR BY STATEMENT:

Name	Joined by	From
Jeanice Sadler	Statement	
Donald "Don" Whitley	Statement	

MEMBERS JOINED BY BAPTISM:

Catherine "Cathy" Cox
Kevin Henley
Andrew Seebo

MEMBERS DROPPED BY TRANSFER TO ANOTHER CHURCH:

Name	Transferred to
-------------	-----------------------

FIRST BAPTIST CHURCH, SUFFOLK, VA
1st QUARTER BUSINESS MEETING
2021 – 2022
October 13, 2021

The 1st Quarter Business Meeting was held on Wednesday, October 13, 2021, with Moderator Mike Dolen presiding.

After prayer and devotion by Pastor Thurman Hayes, Jr., Mr. Dolen called the meeting to order.

Mr. Dolen recognized Cindy Baker, Church Clerk, for the presentation of the minutes of the July 14, 2021, Quarterly Business Meeting. Printed copies were provided in advance. Mrs. Baker made a motion that the minutes be approved as presented. The motion was seconded and carried. (Copy attached.)

Mr. Dolen again recognized Mrs. Baker for the presentation of the 4th quarter 2020-2021 Clerk's Report. (Copy Attached.) Mrs. Baker made a motion to approve the report as presented. The motion was seconded and carried.

Next item of business on the agenda was the Election of Messengers to the SBCV Annual Meeting to be held November 7-9, 2021, at Liberty Live Church in Hampton, VA. Members were encouraged to attend the meeting. They can attend as guests or as messengers. The number of messengers that can vote is limited to 10 for our church. As Chairman of Deacons, Mr. Dolen made a motion that anyone wishing to serve as a messenger for SBCV please contact the church office and those approved as messengers will be affirmed by the deacon officers and the pastor. Motion was seconded and carried.

Mr. Dolen recognized Alan Harris, Chairman of the Finance Committee, for the 4th Quarter June/July/August 2020-2021. (Copy attached.) Mr. Harris made a motion that the report be accepted. Motion was seconded and carried.

Mr. Dolen recognized Patrick Rouse, Chairman of the Properties Committees. The Properties Committee and the Board of Directors are currently considering a request from Suffolk Christian Academy in regard to the use of our facility for the upper school (grades 6-12). Mr. Rouse made the following presentation:

- Properties Committee has received a request for a lease regarding the use of the church facility beginning in August of 2022.
- Request is for the use of selected portions of the church facility for Middle and High School students
- Request would include 5,806 sq. ft. of classroom and office space.
- Request would include the use of the gym, kitchen, resource classrooms, and storage areas. Also, the use of the sanctuary for Thursday chapel and special events in gym and other areas. Music room would also be included.
- Use of gym and locker rooms for athletics would be charged at an additional cost from primary lease.
- Lease costs would include monies for leasing facility and for utilities. The cost of the lease would be charged on a per square foot basis. (\$2.50 sq. ft for facilities and \$2.00 sq. ft for utilities) The total leasing pricing as of the initial request would be \$50,878.
- The classroom space would include primarily use of the second floor of the Traylor Bld., basement of the Goodwin Bld., and old preschool office area. In FLC basement 2 classrooms would be used and the large room would be a limited usage space. Large classroom (A5) would also be a limited usage classroom space.

- The remodeling of the campus was done with the understanding that the school would return. Current enrollment of the Upper School is approximately 89 students. Would also include approximately 20 teachers and office personnel.
- School would begin office use on May 1, 2022. Begin storage space usage on June 1, 2022. Begin use of classroom space as of Aug 1, 2022.
- FBC would be responsible for maintenance of building, grounds, and snow removal.
- School is working toward a permanent option and the use of the facility would be with the understanding on the terms that the school is working to transition to a permanent campus.

The matter was discussed. There will be further reporting regarding this request.

There being no other business, a motion was made for the meeting to be adjourned. Motion was seconded and the meeting was adjourned after closing prayer by Pastor Thurman.

Respectfully Submitted,

Cindy Baker, Church Clerk

FBC Suffolk
Financial Report
1st Quarter
Sep/Oct/Nov
2021-2022

Summary Page

Assets:

General Operating Account	\$	27,663.01
Designated Funds	\$	20,421.84
Total Primary Checking	\$	48,084.85

Savings & Contingency Fund	\$	127,146.10
Building Fund	\$	12,876.92

Scholarship Investments	\$	418,775.12
-------------------------	----	------------

Liabilities:

Building Loan Balance	\$	2,037,222.05
Line of Credit Balance	\$	21,956.86

Quarter-to-Date Receipts	\$	258,615.60
Quarter-to-Date Expenditures	\$	(275,333.38)
Net Difference	\$	(16,717.78) <i>negative</i>

Year-to-Date Receipts	\$	258,615.60
Year-to-Date Expenditures	\$	(275,333.38)
Net Difference	\$	(16,717.78) <i>negative</i>

Accounts

Assets		
Current assets		
Primary Checking Farmers Bank		
01500 - General Operating Account	\$27,663.01	
21130 - Designated Funds	\$20,421.84	
Total Primary Checking Farmers Bank	\$48,084.85	
Savings & Contingency		
01210 - Savings & Conting - Atlantic Union	\$127,146.10	
01250 - Building Fund- Farmers Bank	\$12,876.92	
Total Savings & Contingency	\$140,023.02	
Investments & CDs		
Scholarship Funds TD Ameritrade		
01305 - Kendrick Memorial Scholarship	\$375,452.19	
01450 - Savedge Memorial Scholarship	\$43,322.93	
Total Scholarship Funds TD Ameritrade	\$418,775.12	
Total Investments & CDs	\$418,775.12	
Total Current assets		\$606,882.99
Total Assets		\$606,882.99
Liabilities, Fund Principal, & Restricted Funds		
Liabilities		
Accounts Payable		
02220 - Accounts Payable Accrued	(\$5,193.10)	
Total Accounts Payable		(\$5,193.10)
Bank Loans		
02235 - Building Loan: Farmers Bank	\$2,037,222.05	
02245 - Line of Credit: Farmers Bank	\$21,956.86	
Total Bank Loans		\$2,059,178.91
Total Liabilities		\$2,053,985.81
Fund Principal		
02999 - Fund Principal - Church	(\$2,009,605.02)	
Excess Cash Received	(\$16,717.78)	
Total Fund Principal and Excess Cash Received		(\$2,026,322.80)
Restricted Funds		
Total Temporary Restricted	\$20,421.84	
Total Permanent Restricted	\$558,798.14	
Total Restricted Funds		\$579,219.98
Total Liabilities, Fund Principal, & Restricted Funds		\$606,882.99

FIRST BAPTIST CHURCH SUFFOLK**1st Quarter
Sep/Oct/Nov****2021-2022****SAVINGS & CONTINGENCY FUND-ATLANTIC UNION BANK**

	Prior Balance	Deposits	Withdrawals	TOTAL
Contingency	\$ 49,916.63	\$ 3,003.21	\$ -	\$ 52,919.84
FW Spivey Estate Gift	\$ 9,475.03	\$ -	\$ -	\$ 9,475.03
		TOTAL UNDESIGNATED		\$ 62,394.87
On Mission Fund	\$ 43,391.17	\$ 5,245.00	\$ (442.96)	\$ 48,193.21
Ethnos Ministry: Nashaat Ibrahim	\$ 19,624.77	\$ 100.00	\$ (3,168.27)	\$ 16,556.50
Scholarship Fund	\$ 701.52	\$ -	\$ (700.00)	\$ 1.52
		TOTAL DESIGNATED		\$ 64,751.23
Balance on: Nov 30	\$ 123,109.12	\$ 8,348.21	\$ (4,311.23)	\$ 127,146.10

BUILDING FUND - FARMERS BANK

	Deposits	Withdrawals	TOTAL
Previous Balance:			\$ 15,719.46
Deposits:	Interest \$ 3.74	\$ -	\$ 3.74
	\$ -		\$ -
Withdrawals:		\$ (2,846.28)	\$ (2,846.28)
		\$ -	\$ -
Balance on: Nov 30			\$ 12,876.92

monthly debt obligation: \$15,969.64***interest rate 3.75% renewal 8/28/21 matures: 8/28/26******* principal amount at renewal: \$2,077,504.72********prior agreement date 9/14/2015: \$2,700,000.00****SCHOLARSHIP INVESTMENTS- TDAMERITRADE**

	Prior Balance	Change	ENDING BALANCE
Kendrick Memorial Scholarship Fund	\$ 395,488.49	\$ (20,036.30)	\$ 375,452.19
Savedge Memorial Scholarship Fund	\$ 45,011.54	\$ (1,688.61)	\$ 43,322.93
Total	\$ 440,500.03	\$ (21,724.91)	\$ 418,775.12

FIRST BAPTIST CHURCH SUFFOLK

1st Quarter
Sep/Oct/Nov

2021-2022

RECEIPTS THIS QUARTER

BUDGET RECEIPTS		
September	\$	75,256.26
October	\$	84,267.66
November	\$	74,883.61
TOTAL	\$	234,407.53

OTHER/DESIGNATED RECEIPTS		
September	\$	3,434.85
October	\$	2,879.66
November	\$	17,847.13
TOTAL	\$	24,161.64

BALANCE ON HAND THIS QUARTER: \$ 48,084.85

THIS YEAR'S BUDGET:	\$	1,046,857.00
REQUIREMENTS THIS QTR:	\$	261,714.25
% OF BUDGET REQUIREMENTS THIS QTR:		90%
BUDGET RECEIPTS THIS QTR:	\$	234,407.53
DESIGNATED RECEIPTS THIS QTR:	\$	24,161.64
SPECIAL OFFERINGS THIS QTR:	\$	60,220.44
INTEREST EARNED THIS QUARTER:	\$	46.43
TOTAL RECEIPTS THIS QUARTER:	\$	318,836.04

DESIGNATED RECEIPTS

Baptist Missions	\$	339.00	Samaritan's Purse
Church Planting: Nashaat/Ethnos	\$	3,168.27	xfr from Church Plant savings for Nashaat's expenses
FBC Foreign Missions	\$	709.96	missions fundraisers & xfr from On Mission savings
Benevolence & CAPS	\$	50.00	donations
Discipleship Training	\$	412.00	Deeper Life
Education Resources	\$	12.00	
Music Ministry	\$	130.00	
Children's Ministry	\$	2,209.90	Awana & Outreach
Support Services	\$	386.76	donations to cover fees
Scholarship Awards	\$	6,000.00	from Investments for awards
Vehicle Maintenance	\$	276.00	donations
Church Wide Functions	\$	64.00	
Food Services	\$	222.90	
Maintenance Repairs	\$	3,965.34	draw on LOC for HVAC items
Maintenance Items	\$	3,870.93	gym & building use
Janitorial	\$	21.42	
Posting Credits/Adjustments	\$	2,323.16	
TOTAL DESIGNATED RECEIPTS	\$	24,161.64	

First Baptist Church
Quarterly Revenue & Expense Report
September to November 2021

Accounts	Annual Budget (This Year)	QTD Credits (This Year)	QTD Debits (This Year)	QTD Actual (This Year)	YTD Actual (This Year)	Annual Budget Remaining (This Year)	% of Annual Budget Used (This Year)
Revenues							
04100 - Budget Offerings	\$0.00	\$234,407.53	\$0.00	\$234,407.53	\$234,407.53	(\$234,407.53)	0.00 %
Total Revenues	\$0.00	\$234,407.53	\$0.00	\$234,407.53	\$234,407.53	(\$234,407.53)	0.00 %
Expenses							
World Missions	\$128,600.00	\$4,267.23	\$34,419.81	\$30,152.58	\$30,152.58	\$98,447.42	23.45 %
Personnel	\$537,738.00	\$0.00	\$132,566.63	\$132,566.63	\$132,566.63	\$405,171.37	24.65 %
Thorough Worship	\$6,250.00	\$0.00	\$710.05	\$710.05	\$710.05	\$5,539.95	11.36 %
Education & Discipleship	\$34,800.00	\$1,261.94	\$9,879.79	\$8,617.85	\$8,617.85	\$26,182.15	24.76 %
Music Ministry	\$9,800.00	\$130.00	\$894.57	\$764.57	\$764.57	\$9,035.43	7.80 %
Student Ministry	\$10,800.00	\$126.41	\$2,563.12	\$2,436.71	\$2,436.71	\$8,363.29	22.56 %
Children's Ministry	\$8,500.00	\$2,209.90	\$3,065.95	\$856.05	\$856.05	\$7,643.95	10.07 %
Support Services	\$64,669.00	\$386.76	\$13,394.80	\$13,008.04	\$13,008.04	\$51,660.96	20.11 %
Special Services	\$14,600.00	\$7,726.80	\$11,527.01	\$3,800.21	\$3,800.21	\$10,799.79	26.03 %
Church Properties	\$146,500.00	\$8,052.60	\$46,123.90	\$38,071.30	\$38,071.30	\$108,428.70	25.99 %
Capital Improvements	\$84,600.00	\$0.00	\$20,187.75	\$20,187.75	\$20,187.75	\$64,412.25	23.86 %
Total Expenses	\$1,046,857.00	\$24,161.64	\$275,333.38	\$251,171.74	\$251,171.74	\$795,685.26	23.99 %
Other Revenues							
06000 - Bank Interest Income		\$258,569.17	\$275,333.38	(\$16,764.21)	(\$16,764.21)	(\$1,030,092.79)	0.00 %
Total Other Revenues	\$0.00	\$46.43	\$0.00	\$46.43	\$46.43	(\$46.43)	0.00 %
Net Operating Total	(\$1,046,857.00)	\$258,615.60	\$275,333.38	(\$16,717.78)	(\$16,717.78)	(\$1,030,139.22)	0.00 %

First Baptist Church
Summary of Restricted Accounts
September to November 2021

Accounts

	Beginning Balance	Restricted Revenue	Restricted Expenses	Credit Adjustments	Debit Adjustments	Ending Balance
Temporary Restricted						
Missions Offerings						
28500 - Lottie Moon	\$0.00	\$0.00	\$0.00	\$7,093.41	\$7,093.41	\$0.00
28501 - Annie Armstrong	\$0.00	\$0.00	\$0.00	\$0.00	\$0.00	\$0.00
28502 - State Missions	\$0.00	\$0.00	\$0.00	\$1,775.00	\$1,775.00	\$0.00
28805 - Church Plant: Ethnos: Nashaat	\$0.00	\$0.00	\$0.00	\$600.00	\$600.00	\$0.00
28806 - Baptist Missions Designations	\$690.68	\$0.00	\$0.00	\$1,951.17	\$1,783.70	\$858.15
28807 - On Mission Fund	\$0.00	\$0.00	\$0.00	\$5,245.00	\$5,245.00	\$0.00
28816 - Romania Special Gifts	\$1,372.25	\$0.00	\$0.00	\$975.00	\$0.00	\$2,347.25
Total Missions Offerings	\$2,062.93	\$0.00	\$0.00	\$17,639.58	\$16,497.11	\$3,205.40
Building & Maintenance Funds						
28300 - Building/Maintenance Gifts	\$918.05	\$0.00	\$0.00	\$0.00	\$0.00	\$918.05
28444 - Building Fund Offerings	\$0.00	\$0.00	\$0.00	\$32,271.00	\$32,271.00	\$0.00
28450 - Building Fund Expenses	\$0.00	\$0.00	\$0.00	\$47,908.92	\$47,908.92	\$0.00
28455 - Building Campaign Expenses	\$1,622.90	\$0.00	\$0.00	\$0.00	\$0.00	\$1,622.90
Total Building & Maintenance Funds	\$2,540.95	\$0.00	\$0.00	\$80,179.92	\$80,179.92	\$2,540.95
Other Designated Funds						
28800 - CD Ministry Fund	\$1,496.14	\$0.00	\$0.00	\$280.00	\$300.00	\$1,476.14
28801 - Student Camp Fund	\$292.21	\$0.00	\$0.00	\$0.00	\$0.00	\$292.21
28802 - Love Offering	\$0.00	\$0.00	\$0.00	\$800.00	\$800.00	\$0.00
28803 - Baptist Men's Class Fund	\$187.71	\$0.00	\$0.00	\$0.00	\$0.00	\$187.71
28804 - First Aid Ministry	\$4,008.34	\$0.00	\$0.00	\$0.00	\$0.00	\$4,008.34
28811 - Pastor's Discipleship Books	\$0.00	\$0.00	\$0.00	\$1,572.60	\$135.92	\$1,436.68
28812 - Deacon Ministry Designations	\$0.00	\$0.00	\$0.00	\$1,025.00	\$0.00	\$1,025.00
28813 - Library/Pastor's Office Renovation	\$0.00	\$0.00	\$0.00	\$707.34	\$0.00	\$707.34
28814 - Student Ministry Fund	\$4,263.16	\$0.00	\$0.00	\$2,290.66	\$4,669.41	\$1,884.41
28817 - Special Events/Trips	\$2,277.55	\$0.00	\$0.00	\$3,142.70	\$4,672.50	\$747.75
28818 - Suffolk Towers Aid	\$7,679.08	\$0.00	\$0.00	\$0.00	\$5,621.16	\$2,057.92
28819 - Children's Ministry Designations	(\$1,271.50)	\$0.00	\$0.00	\$2,771.50	\$2,373.95	(\$873.95)
28820 - Media/AV Ministry Fund	\$0.00	\$0.00	\$0.00	\$1,725.94	\$0.00	\$1,725.94
Total Other Designated Funds	\$18,932.69	\$0.00	\$0.00	\$14,315.74	\$18,572.94	\$14,675.49
Total Temporary Restricted	\$23,536.57	\$0.00	\$0.00	\$112,135.24	\$115,249.97	\$20,421.84

First Baptist Church
Summary of Restricted Accounts
September to November 2021

Accounts

	Beginning Balance	Restricted Revenue	Restricted Expenses	Credit Adjustments	Debit Adjustments	Ending Balance
Permanent Restricted						
Scholarship Investments						
09005 - Kendrick Scholarship TD Ameritrade	\$395,488.49	\$0.00	\$0.00	\$17,258.35	\$37,294.65	\$375,452.19
09400 - Savedge Scholarship TD Ameritrade	\$45,011.54	\$0.00	\$0.00	\$2,143.12	\$3,831.73	\$43,322.93
Total Scholarship Investments	\$440,500.03	\$0.00	\$0.00	\$19,401.47	\$41,126.38	\$418,775.12
Contingency Fund						
09100 - Contingency Savings Fund-Union Bank	\$59,391.66	\$0.00	\$0.00	\$3,003.21	\$0.00	\$62,394.87
09103 - Contingency Library Renovations	\$707.34	\$0.00	\$0.00	\$0.00	\$707.34	\$0.00
09104 - Contingency On Mission	\$43,391.17	\$0.00	\$0.00	\$5,245.00	\$442.96	\$48,193.21
09105 - Contingency Nashaat Ibrahim	\$19,624.77	\$0.00	\$0.00	\$100.00	\$3,168.27	\$16,556.50
09106 - Contingency Discipleship Books	\$1,572.60	\$0.00	\$0.00	\$0.00	\$1,572.60	\$0.00
09107 - Contingency Scholarship Fund	\$701.52	\$0.00	\$0.00	\$0.00	\$700.00	\$1.52
09109 - Contingency Deacon Ministry	\$0.00	\$0.00	\$0.00	\$0.00	\$0.00	\$0.00
09110 - Contingency Media Ministry	\$1,725.94	\$0.00	\$0.00	\$0.00	\$1,725.94	\$0.00
09111 - Contingency Designated/Other	\$0.00	\$0.00	\$0.00	\$0.00	\$0.00	\$0.00
Total Contingency Fund	\$127,115.00	\$0.00	\$0.00	\$8,348.21	\$8,317.11	\$127,146.10
Building Fund						
09350 - Building Fund Farmers	\$15,719.46	\$0.00	\$0.00	\$3.74	\$2,846.28	\$12,876.92
Total Building Fund	\$15,719.46	\$0.00	\$0.00	\$3.74	\$2,846.28	\$12,876.92
Total Permanent Restricted	\$583,334.49	\$0.00	\$0.00	\$27,753.42	\$52,289.77	\$558,798.14



January 9, 2022

RE: Proposal from Suffolk Christian Academy

The Board of Directors of First Baptist Church (FBC) recommends the approval of a proposal from Suffolk Christian Academy (SCA) for the lease of the FBC facility for the operation of their Upper School beginning with the 2022-2023 school year. The church would enter into a lease agreement for two years with SCA as outlined below:

Basements (FLC, Traylor, Goodwin)

- 4 classrooms for middle school (Goodwin)
- Storage area for middle school lockers (Goodwin)
- 2 classrooms for Science Lab, Art/classroom (Family Life Center)
- Locker rooms for physical education and bathrooms (Family Life Center)
- Adult 5 for resource classroom (Traylor)

First Floor

- Kitchen – for the preparation of lunches
- Gym – for physical education and lunch cafeteria
- Sanctuary for chapel (Thursday)
- Offices – Main reception area in Goodwin building for an administrative assistant, 4 adjoining rooms for office space [accounting & assistant, headmaster, admissions/guidance, development, IT/HR]
- Permission to use Adult 7 for pre-approved dates for training or staff meetings
- Music room – music classes and drama

Second Floor (Traylor, Goodwin)

- 5 classrooms on main hall (Traylor)
- 2 classrooms (Goodwin)
- Breakroom (Traylor)
- Large Room & side rooms (Traylor) Includes 3 offices for upper school, library & lockers
- 1 office for principal (in connecting hallway of Traylor)



The gym and locker rooms will be available to the SCA for additional costs when used for practices and games.

After -school care and summer programs will also have an additional fee for facilities and utilities.

Pricing

Based on the Square footage requested, the pricing will be as follows:

- \$30,698 for classroom and facility usage per year
- \$35,843 for utility reimbursement per year

FBC will review the utility portion of this payment quarterly and make appropriate changes that can be fully attributed to the school's consumption.

Facility

Classrooms impacted are indicated on the handouts attached.

All impacted classes will continue to have adult sized furniture in their classrooms. Adult Bible Study classes should be able to function normally, and church staff will work with FBC teachers regarding set-up and potential impacts.

SCA will provide custodial services for the space used by the school. Also, an additional dumpster will be utilized by SCA for their trash removal.

Purpose

We have the privilege of being the founding church of Suffolk Christian Academy (originally First Baptist School) and we continue in partnership with Suffolk Christian Academy as a foundational church.

First Baptist has a strong history of Christian education and a passion for making disciples through spiritual and educational formation. The presence of the school for a limited time will allow us to continue to minister to students and their families.



FOR REFERENCE ONLY



Fire Department
207 N. MAIN STREET
SUFFOLK, VA 23404

FIRST BAPTIST
CHURCH SUFFOLK

207 N. MAIN STREET
SUFFOLK, VA 23404



PROJECT: 132013
DATE: 02/20/15 9:46 AM

OVERALL FIRST FLOOR
PLAN

2

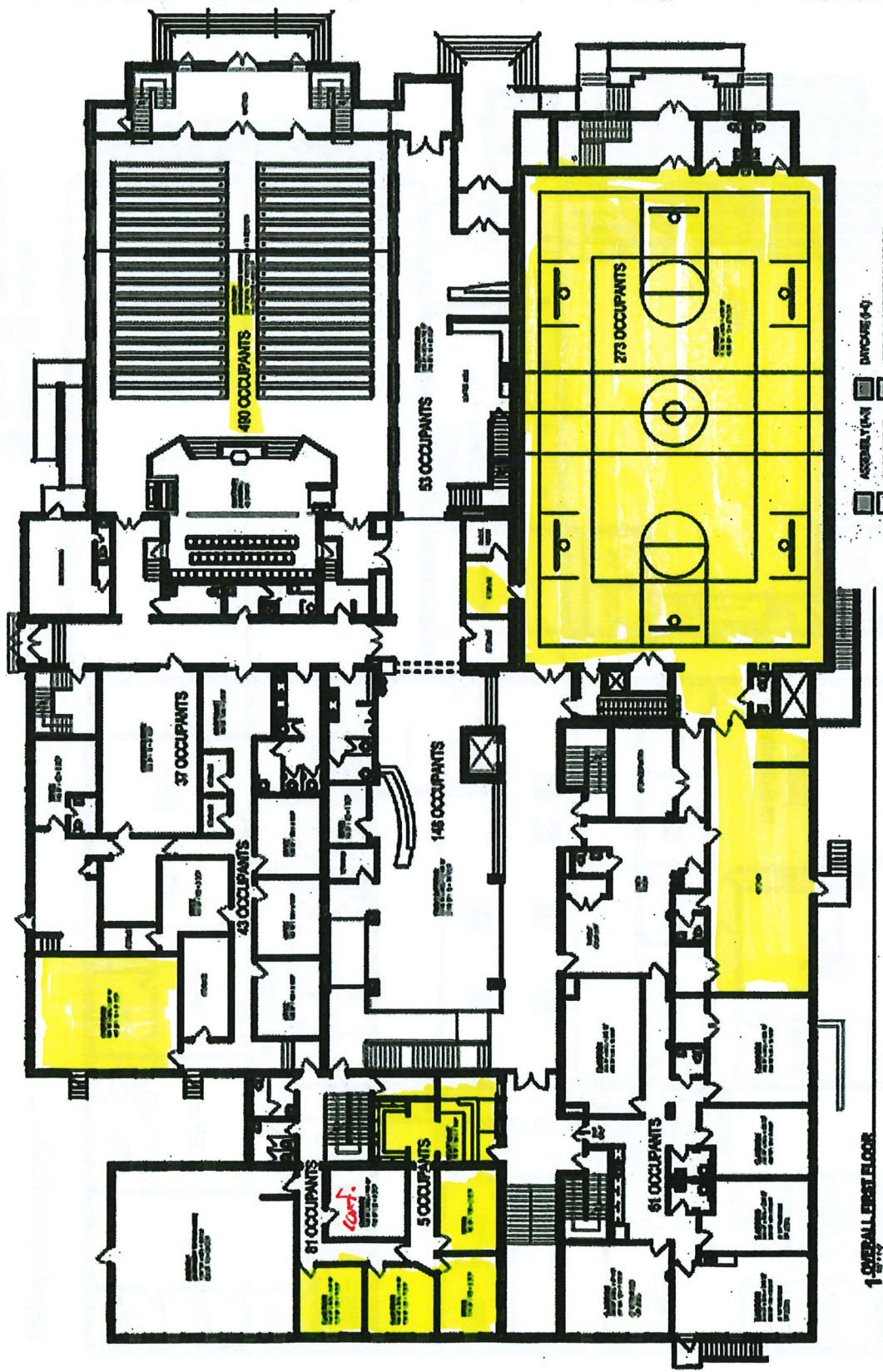

- ASSEMBLY (A-1)
- BUSINESS (B)
- EDUCATION (E)
- DANCE (D-1)
- ATTORNEY (ACCIDENT TO A-1)



FOR REFERENCE
ONLY

Virginia Department of Fire-Related Services
1000 North 10th Street
Richmond, VA 23219

Virginia Department of Fire-Related Services
1000 North 10th Street
Richmond, VA 23219

FIRST BAPTIST
CHURCH SUFFOLK

237 N. MAIN STREET
SUFFOLK, VA 23064



PROJECT: 137023
DATE: 8/20/04 10:28:41 AM

OVERALL SECOND
FLOOR PLAN

3



1 OVERALL SECOND FLOOR PLAN



FOR REFERENCE
ONLY

Virginia Department of Fire-Related Services

8800 South Lakeshore Drive
Suite 100
Falls Church, VA 22041
703.291.1400

FIRST BAPTIST
CHURCH SUFFOLK

217 N. MAIN STREET
SUFFOLK, VA 23404



PROJECT # 130023
DATE: 8/20/2014 10:25:20 AM

OVERALL BASEMENT
FLOOR PLAN

1



Suffolk Christian Academy Rental Proposal Frequently Asked Questions

What is the purpose of allowing Suffolk Academy to lease our facility?

Due to our partnership with Suffolk Christian Academy (SCA) and the privilege we have of being the founding church of SCA, we have been asked to consider the upper school returning to our campus. First Baptist has a strong history of Christian education and a passion for making disciples through spiritual and educational formation. The presence of the school for a limited time will allow us to continue to minister to students and their families.

What areas of the church will be impacted?

The school will occupy selected areas of the Goodwin, Traylor, and Family Life Center buildings. Areas are indicated on information provided for school usage.

How will this impact Adult Bible Study classes?

All classes will continue to have adult sized furniture in their classrooms. The lease for the school states how the rooms are to be maintained and it places limitations for rooms regarding items on the walls. Adult Bible Study classes should be able to function normally, and church staff will work with teachers regarding set-up and potential impacts.

How will the church gain financially?

The church will receive monies for the leasing of the property and reimbursement for utilities. The monies for the lease, \$2,600 per month, will be designated to a contingency fund for the maintenance of the building and upgrades to aging heat and A/C systems. This will allow us to address areas that are vital to our facilities and to make necessary upgrades.

How will this increase utilities and maintenance costs?

The Properties Committee has reviewed the potential costs of the utilities and estimated increases. The school will pay for increases in utility costs and these costs will be reviewed each quarter to ensure any adjustments needed.

Will the church have a greater insurance liability?

Church will be added as "additional insured" to the policies for SCA. Provisions are made in the lease for liability.

Do we have safety protocols in place?

Yes. Many improvements regarding safety were addressed in the renovation project. Safety doors, cameras, scan cards, office locations, and other items were addressed to ensure additional safety.

What ages will be on our campus?

Middle/High School ages will be on our campus. Also, the school will lease the gym for sports and afterschool activities as needed.

Will this change impact Bible Study Fellowship (BSF) on Tuesdays?

We will be able to accommodate BSF and SCA on our campus on Tuesday mornings. BSF will continue to have access to all preschool and children's areas. Classrooms in the Student Center and designated larger rooms on our facility will be available to BSF.

How does this change the church support of the school?

We are looking forward to continuing our support for SCA. The Properties Committee and the Board of Directors did not consider changes to monies already budgeted to SCA. These funds are allocated by the Finance Committee. These support monies also give the ability for full time church employees to receive a significant reduction in tuition. This is a staff benefit.

